

Cut out

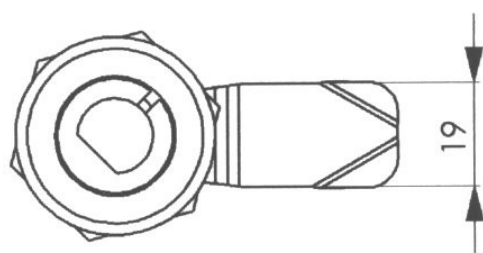

Version	Cat.No.
powder coating (RAL 9005)	03.459
Zinc plated	03.460
Nickel plated	03.461
brass	03.462

Insert of the lock is divided.
The front part is fixed. The rear part is rotating and moves the cam in the range 90°. The cam is held in the basic position by the torsion spring

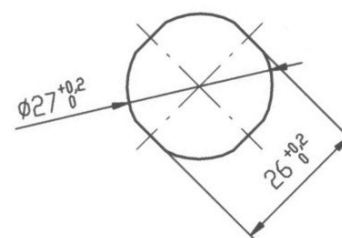

Material : Body of the lock, insert and nut are made of brass.
Surface finish of body: nickel plating, zinc plating, powder coating (RAL 9005) or without surface finish.

Cam : steel, zinc plated

Order example of lock with surface finish black powder coating
: **Lock CZ -E1 03.459**