

Ceiling lamps with microwave sensor

IP40	230V		
------	------	--	--

power LED modules [W]	design of LED modules	light color [K]	luminous flux [lm]
16	PURE WHITE	5600	1590
16	WARM WHITE	3000	1300

SHADE - GLASS
METAL BASE - WHITE PAINTED

LIGHT SOURCE - POWER LED MODULES 16W
MICROWAVE SENSOR

code	eulum data	φD(mm)	φd(mm)	v(mm)	number of LED modules	W	shade
15685	●	310	244	120	1	16	opal-matt

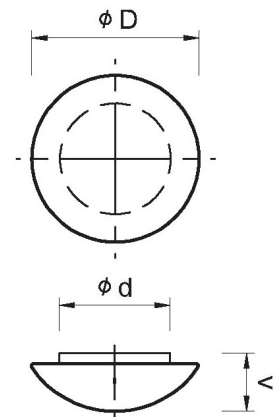

detection angle: 360°
reach: 1-8m (adjustable)
time setting: 8s - 12min
light control: 2lx - 2000lx

